

RS-232 to RS-422/485 Converter with 3KV Isolation Protection

(ID-SC0E11-S1)

User's Manual



04-0779A

Introduction

The serial converter converts RS-232 signals to RS-422 or RS-485 and extends the communication range

Features

- High- speed transmission up to 230.4 Kbps
- Compact size
- Converts RS-232 signal to RS-422, and both 2/4 wire RS-485
- RS-485 auto direction flow control
- 15KV ESD immunity to serial interface
- 3KV Ground isolation
- Wall mount support

Package Contents

- RS-232 to RS-422/485 Converter with 3KV Isolation Protection
- 5-pin terminal block
- USB cable
- Screws (2)
- User's manual

Connection Diagram

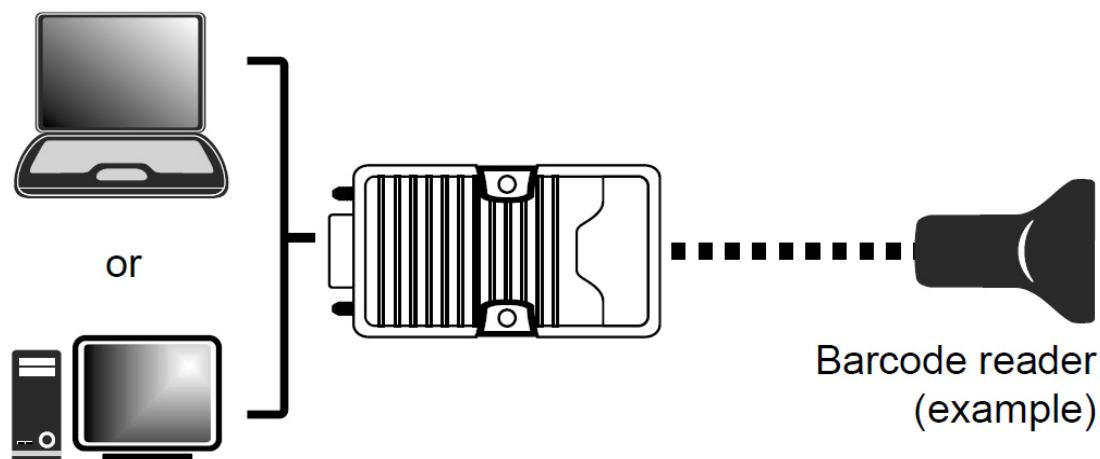

Product Overview

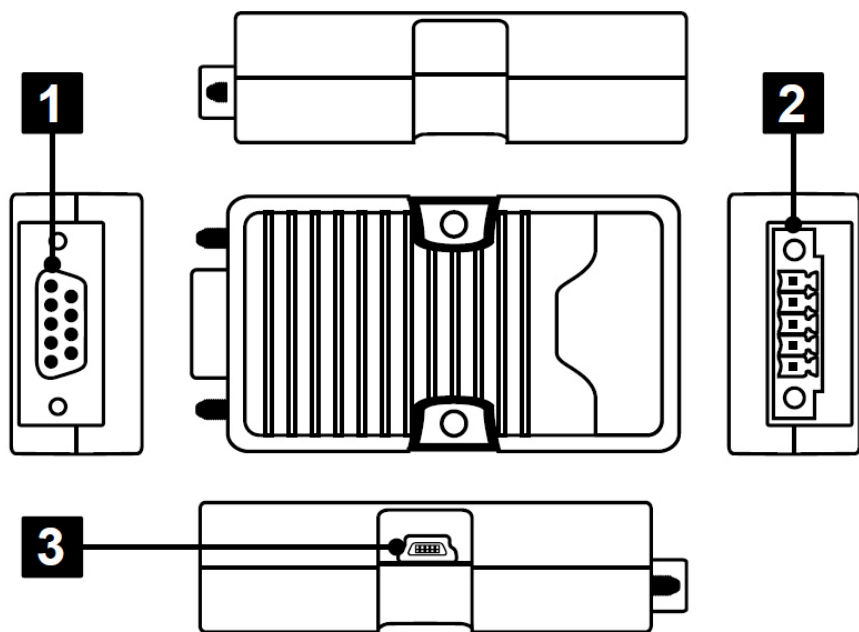

- 1. RS-232
- 2. RS-422/485
- 3. Mini USB Type-B plug (optional for additional power)

External Power

If the connected device requires more power than the converter can provide, use the included **USB cable** to connect the converter to your computer's USB port or USB wall power adapter (not included).

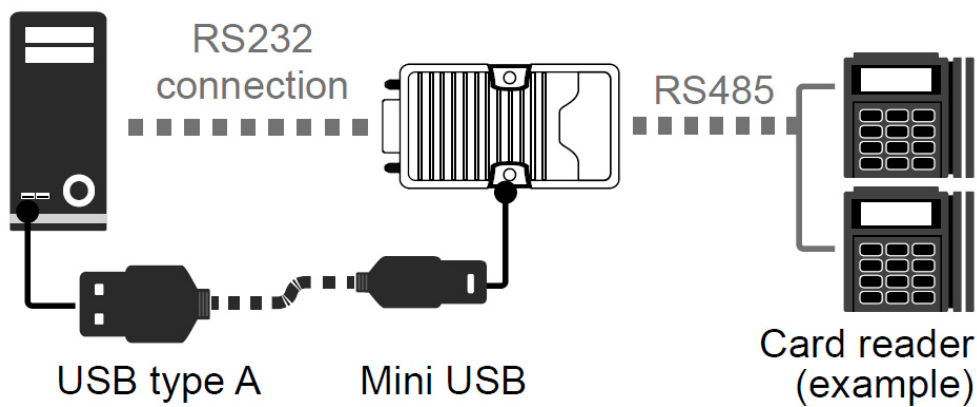

Alternatively

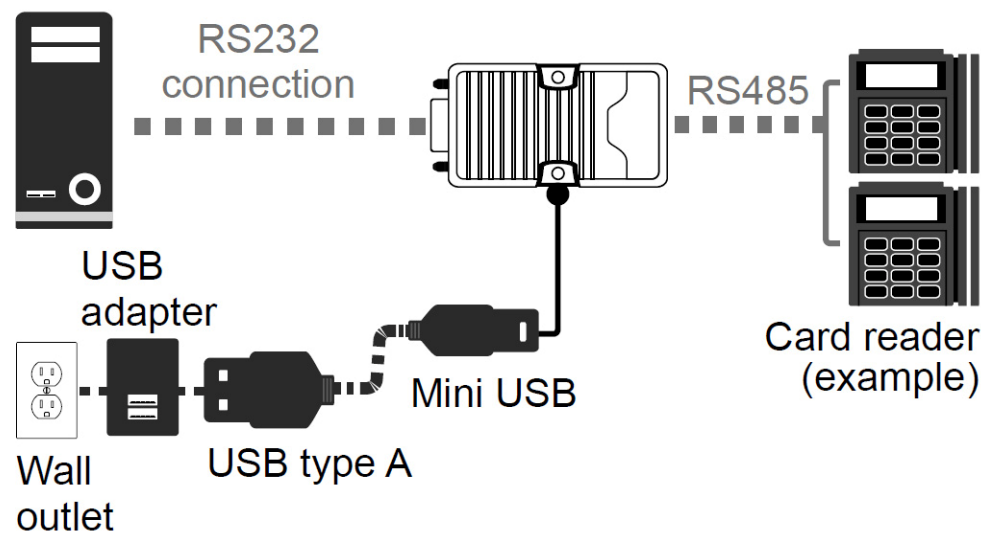

Pin Assignment

DB9 Connector

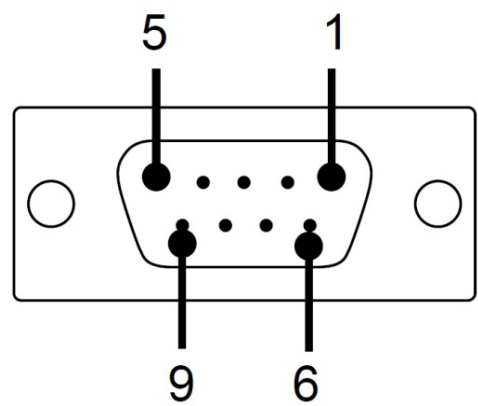

DB9	
1	DCD
2	TxD
3	RxD
4	DSR
5	GND
6	DTR
7	CTS
8	RTS
9	---

5 Pin Terminal Block

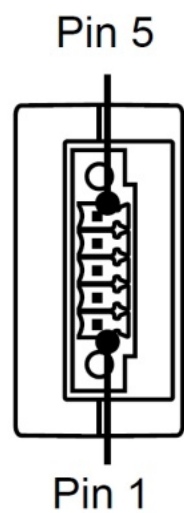

Pin	RS-422	RS-485 (4-wire)	RS-485 (2-wire)
1	TX+	TX+	Data+(A)
2	TX-	TX-	Data-(B)
3	RX+	RX+	---
4	RX-	RX-	---
5	GND	GND	GND

Dip Switch and Jumper Settings

The converter’s default setting is RS-422. To change the operation mode, make the following changes to the dip switch and jumpers

Open the converter's cover

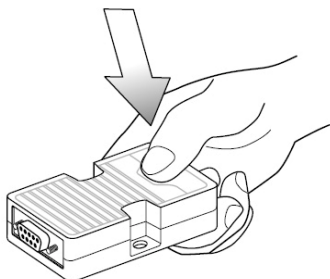

Hold the lower cover, push and slide the upper cover

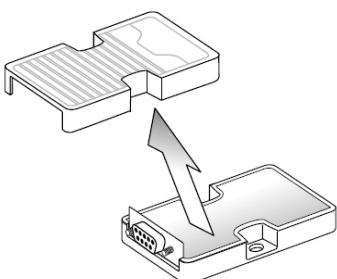
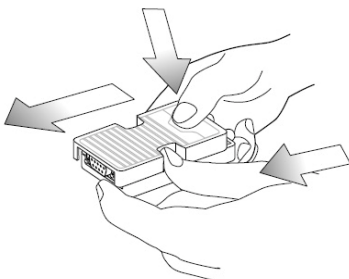

Remove the upper cover

Adjust the dip switch

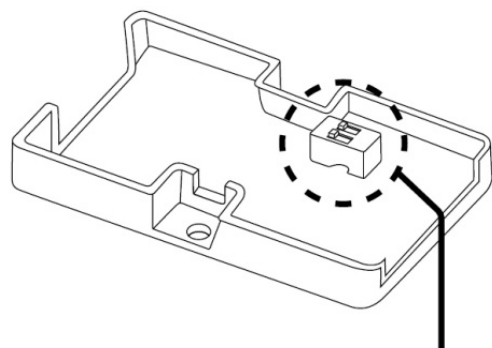

Dip switch

	SW1	SW2
RS-485	On	Off
RS-422	Off	On

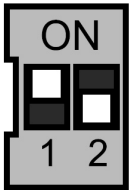

RS-485

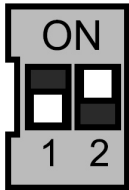

RS-422

Jumper settings

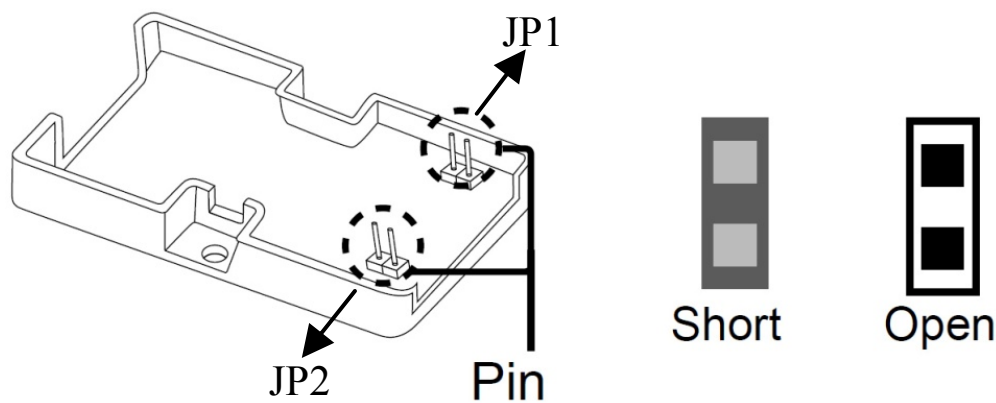

		JP1	JP2
RS422	Default	Short	Short
RS485	4-Wire	Short	Short
RS485	2-Wire	Short	Open

Close the cover

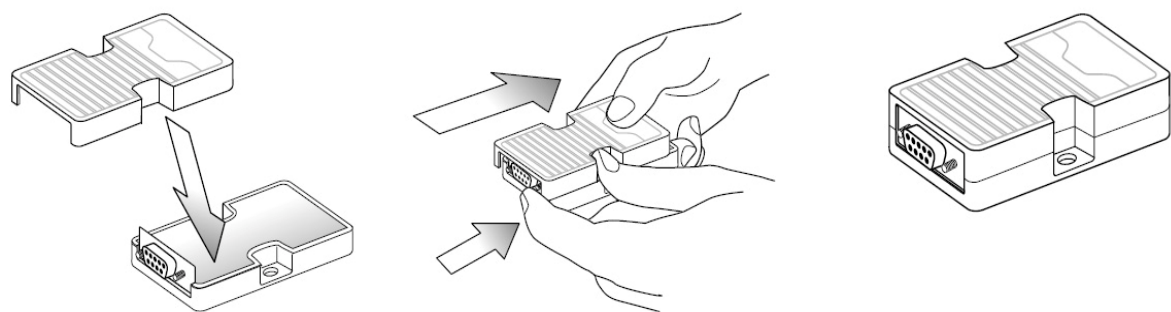

Hold the lower cover and push the upper cover back into the lock position

Properly locked with a click

Wall Mount Assembly

Tighten 2 screws through the screw holes using a screw driver as shown.

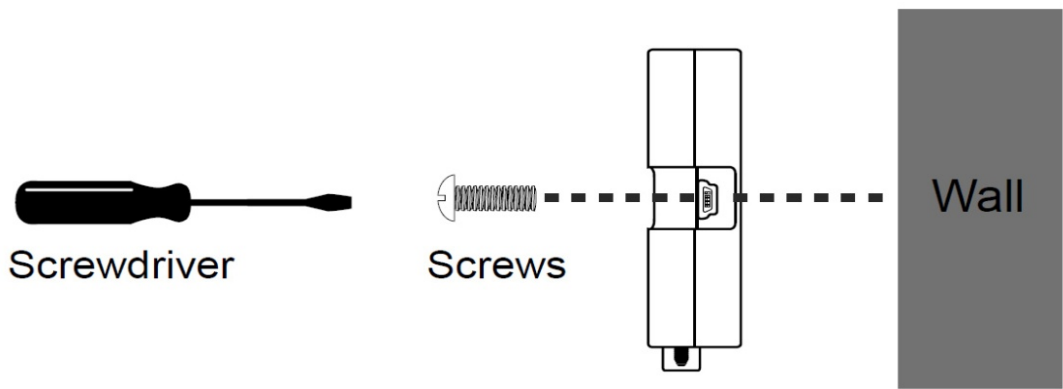

5 Pin Terminal Block Assembly

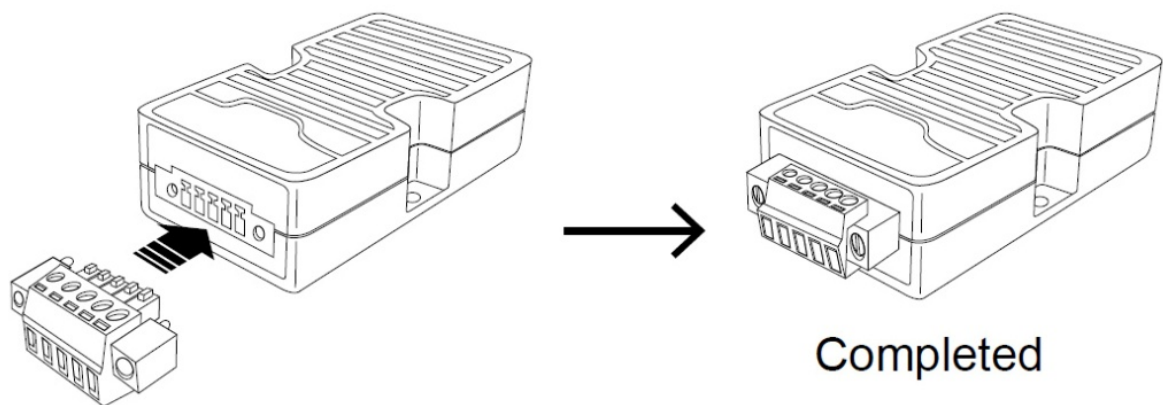

Insert the Cable

1. Insert the cable into the slot.

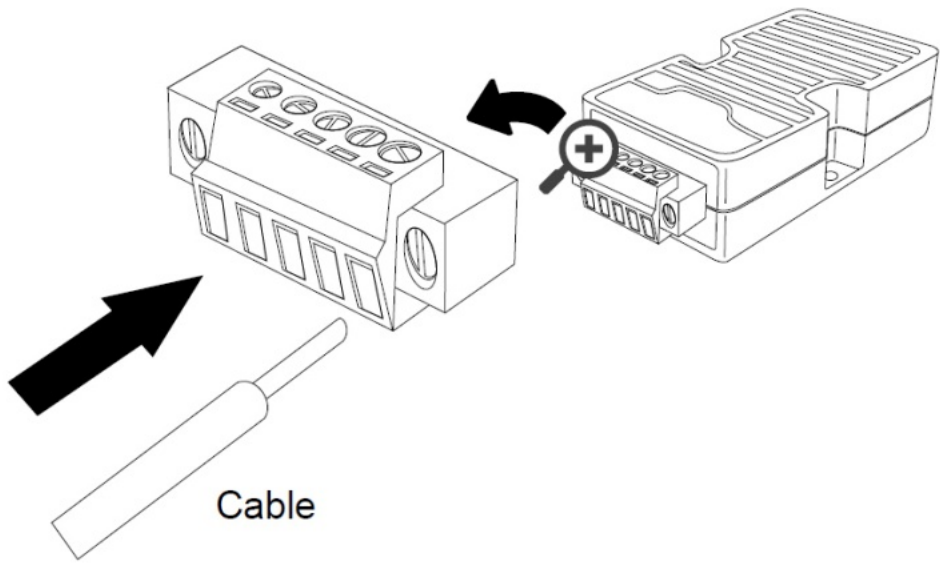

2. Tighten the screw.

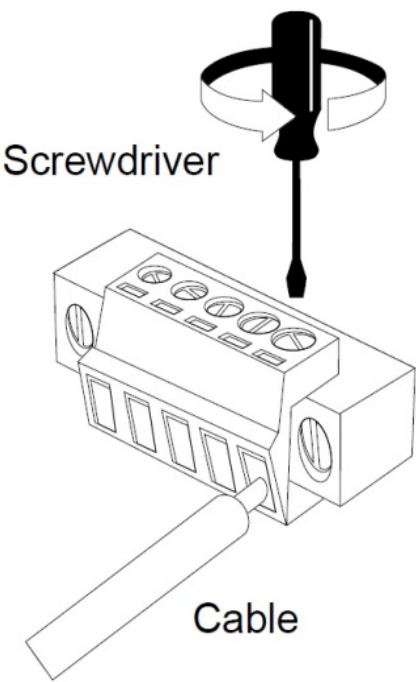

Specifications

Item	Description
Ports	1x RS-422/485
Connector	5 pin terminal block
FIFO	512 bytes
ESD Protection	15KV ESD, 2KV isolation
Serial Communication	Signals for RS-232: TxD, RxD, GND
	Baud rate: 230.4 Kbps
Interface	RS-232
Interface Connector	Female DB9, Mini USB
Power	Serial Power Source: TxD, RTS, DTR
	External Power (USB): 5V
	Operating Current: <40 mA @ 5 VDC
Operating Temperature	0~60°C
Operating Humidity	5~95% RH
Regulatory Approvals	FCC/CE

Specification is subject to change without further notice

Technical Support and Warranty

QUESTIONS? SIIG's **Online Support** has answers! Simply visit our website at www.siig.com and click on **Support**. Our online support database is updated daily with new drivers and solutions. Answers to your questions could be just a few clicks away. You can also submit questions online and one of our technical support analysts will promptly respond.

SIIG offers a 3-year manufacturer warranty with this product. This warranty covers the original purchaser and guarantees the product to be free of any defects in materials or workmanship for three (3) years from the date of purchase of the product.

SIIG will, at our discretion, repair or replace (with an identical product or product having similar features and functionality) the product if defective in materials or workmanship. This warranty gives you specific legal rights, and you may also have other rights which vary from state to state. Please see our web site for more warranty details.

A) If it is within the store's return policy period, please return the product to the store where you purchased from.

B) If your purchase has passed the store's return policy period, please follow these steps to have the product repaired or replaced.

Step 1: Submit your RMA request.

Go to www.siig.com, click **Support**, then **REQUEST A PRODUCT REPLACEMENT**, then RMA to submit a request to **SIIG RMA** or fax a request to 510-657-5962. Your RMA request will be processed, if the product is determined to be defective, an RMA number will be issued.

Step 2: After obtaining an RMA number, ship the product.

- Properly pack the product for shipping. All software, cable(s) and any other accessories that came with the original package must be included.
- Clearly write your RMA number on the top of the returned package. SIIG will refuse to accept any shipping package, and will not be responsible for a product returned without an RMA number posted on the outside of the shipping carton.
- You are responsible for the cost of shipping the product to SIIG at the following address:

SIIG, Inc.

6078 Stewart Avenue

Fremont, CA 94538-3152, USA

RMA #: _____

- SIIG will ship the repaired or replaced product via Ground in the U.S. and International Economy outside of the U.S. at no cost to the customer.

About SIIG, Inc.

Founded in 1985, SIIG, Inc. is a leading manufacturer of IT connectivity solutions (including Serial ATA and Ultra ATA Controllers, FireWire, USB, and legacy I/O adapters) that bridge the connection between Desktop/ Notebook systems and external peripherals. SIIG continues to grow by adding A/V and Digital Signage connectivity solutions to our extensive portfolio. All centered around the distribution and switching of A/V signals over CAT5/6, these products include matrix switches, distribution amplifiers, extenders, converters, splitters, cabling, and more.

SIIG is the premier one-stop source of upgrades and is committed to providing high quality products while keeping economical and competitive prices. High-quality control standards are evident by one of the lowest defective return rates in the industry. Our products offer comprehensive user manuals, user-friendly features, and most products are backed by a lifetime warranty.

SIIG products can be found in many computer retail stores, mail order catalogs, and e-commerce sites in the Americas, as well as through major distributors, system integrators, and VARs.

PRODUCT NAME

RS-232 to RS-422/485 Converter with 3KV Isolation Protection

**FCC RULES: TESTED TO COMPLY WITH FCC PART 15, CLASS
B OPERATING ENVIRONMENT: FOR HOME OR OFFICE USE**

FCC COMPLIANCE STATEMENT:

This device complies with part 15 of the FCC Rules. Operation is subject to the following two conditions: (1) This device may not cause harmful interference, and (2) this device must accept any interference received, including interference that may cause undesired operation.

THE PARTY RESPONSIBLE FOR PRODUCT COMPLIANCE

SIIG, Inc.
6078 Stewart Avenue
Fremont, CA 94538-3152, USA
Ph: 510-657-8688

RS-232 to RS-422/485 Converter with 3KV Isolation Protection is a trademark of SIIG, Inc. SIIG and the SIIG logo are registered trademarks of SIIG, Inc. Other names used in this publication are for identification only and may be trademarks of their respective companies.

April, 2012

Copyright © 2012 by SIIG, Inc. All rights reserved.