



# USB 3.1 2-Port PCIe Host Adapter(1x) - Type-A

## Installation Guide

### Introduction

---

The *USB 3.1 2-Port PCIe Host Adapter(1x) - Type-A* adds two USB 3.1 ports to your PCIe-enabled desktop PC, and the latest USB 3.1 technology supports data transfer rate up to 10Gb/s (Two times faster than USB 3.0).

### Key Features and Benefits

- Simply add two USB 3.1 Type-A to your desktop computer via an available PCI Express bus slot
- Supports plug-n-play, hot-swappable, and backwards compatible with USB 3.0 / 2.0 / 1.1
- Built-in SATA power connector to connect with system power supply as needed to ensure sufficient power supplied through USB port

- Dual-profile bracket design (Full & Low Profile) fits different system form factor with included low profile bracket
- Each USB port provides power output up to 900mA to better support the power consumption of connected device
- Each USB port featured with independent over-current protection to further protect your device

## **Package Contents**

- USB 3.1 2-Port PCIe Host Adapter(1x) - Type-A
- Low profile bracket
- Installation guide

## **System Requirements**

- Desktop PC with one available PCIe slot 1x
- Windows 8.1 / 8
- Various Linux Kernels

# Layout

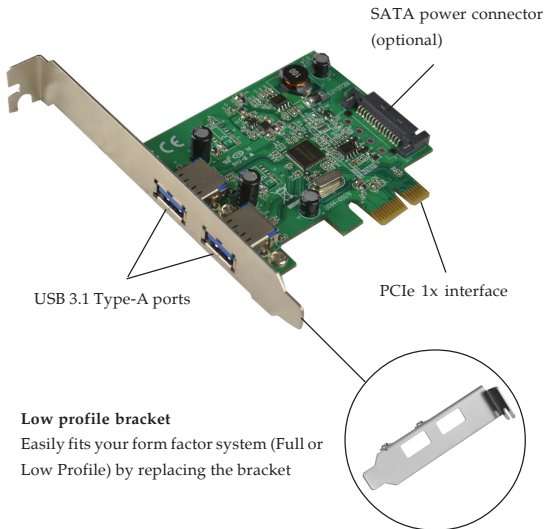

**Figure 1: Layout**

**\*Note:** The host adapter will work with or without the SATA power connected. However, we recommend this connection if your USB devices are not recognized, lose connection to Windows randomly or all ports are connected to USB devices.

## Hardware Installation

---

Since the design of computer cases and motherboards vary, refer to your computer's reference manual for further information.

Static Electricity Discharge may permanently damage your system. Discharge any static electricity build up in your body by touching your computer case for a few seconds. Avoid any contact with internal parts and handle cards only by their external edges.

1. Turn OFF the power to your computer and any other connected peripheral devices.
2. Unplug the power cord from the computer.
3. Remove your computer cover.
4. Remove the slot bracket from an available PCIe slot.
5. Carefully align the card's bus connector with the selected PCI Express slot on the motherboard. Push the card down firmly, but gently, until it is well seated.
6. Replace the slot bracket holding screw to secure the card.

7. Connect the system power supply to the cards's **SATA power connector**. This connection is optional. Please see **Layout** on page 3 for more information.
8. Replace the computer cover and reconnect the power cord.

## **Windows Driver Installation**

---

Windows 8.1 and 8 have built-in driver support for this adapter. Just install the board and Windows will automatically detect and install the correct drivers for it. No additional driver is needed.

### **To Verify Installation**

1. Right click **This PC** or **Computer** on the desktop, click **Manage**, then click **Device Manager**.
2. Double click **Universal Serial Bus controllers**, and **ASMedia USB ... Controller** should be displayed.

**Blank Page**

# Technical Support and Warranty

---

**QUESTIONS?** SIIG's **Online Support** has answers! Simply visit our web site at [www.siig.com](http://www.siig.com) and click **Support**. Our online support database is updated daily with new drivers and solutions. Answers to your questions could be just a few clicks away. You can also submit questions online and a technical support analyst will promptly respond.

SIIG offers a 3-year manufacturer warranty with this product. This warranty covers the original purchaser and guarantees the product to be free of any defects in materials or workmanship for three (3) years from the date of purchase of the product.

SIIG will, at our discretion, repair or replace (with an identical product or product having similar features and functionality) the product if defective in materials or workmanship. This warranty gives you specific legal rights, and you may also have other rights which vary from state to state. Please see our web site for more warranty details.

If you encounter any problems with this product, please follow the procedures below.

A) If it is within the store's return policy period, please return the product to the store where you purchased from.

B) If your purchase has passed the store's return policy period, please follow the steps below to have the product repaired or replaced.

**Step 1:** Submit your RMA request.

Go to [www.siig.com](http://www.siig.com), click **Support**, then **REQUEST A PRODUCT REPLACEMENT** to submit a request to **SIIG RMA** or fax a request to 510-657-5962. Your RMA request will be processed, if the product is determined to be defective, an RMA number will be issued.

**Step 2:** After obtaining an RMA number, ship the product.

- Properly pack the product for shipping. All accessories that came with the original package must be included.
- Clearly write your RMA number on the top of the returned package. SIIG will refuse to accept any shipping package, and will not be responsible for a product returned without an RMA number posted on the outside of the shipping carton.
- You are responsible for the cost of shipping to SIIG. Ship the product to the following address:

**SIIG, Inc.**

**6078 Stewart Avenue**

**Fremont, CA 94538-3152, USA**

**RMA #:** \_\_\_\_\_

- SIIG will ship the repaired or replaced product via Ground in the U.S. and International Economy outside of the U.S. at no cost to the customer.

## About SIIG, Inc.

---

Founded in 1985, SIIG, Inc. is a leading manufacturer of IT connectivity solutions (including Serial ATA and Ultra ATA Controllers, FireWire, USB, and legacy I/O adapters) that bridge the connection between Desktop/Notebook systems and external peripherals. SIIG continues to grow by adding A/V and Digital Signage connectivity solutions to our extensive portfolio.

SIIG products offer comprehensive user manuals, many user-friendly features, and are backed by an extensive manufacturer warranty. High quality control standards are evident by the overall ease of installation and compatibility of our products, as well as one of the lowest defective return rates in the industry. SIIG products can be found in computer retail stores, mail order catalogs, through major distributors, system integrators, and VARs in the Americas and the UK, and through e-commerce sites.

### **PRODUCT NAME**

USB 3.1 2-Port PCIe Host Adapter(1x) - Type-A

FCC RULES: TESTED TO COMPLY WITH FCC PART 15, CLASS B  
OPERATING ENVIRONMENT: FOR HOME OR OFFICE USE

### **FCC COMPLIANCE STATEMENT:**

This device complies with part 15 of the FCC Rules. Operation is subject to the following two conditions: (1) This device may not cause harmful interference, and (2) this device must accept any interference received, including interference that may cause undesired operation.

### **THE PARTY RESPONSIBLE FOR PRODUCT COMPLIANCE**

SIIG, Inc.

6078 Stewart Avenue

Fremont, CA 94538-3152, USA

Phone: 510-657-8688

USB 3.1 2-Port PCIe Host Adapter(1x) - Type-A is a trademark of SIIG, Inc. SIIG and the SIIG logo are registered trademarks of SIIG, Inc. All other names used in this publication are for identification only and may be trademarks of their respective owners.