

Triple Monitor Desk Mount 13" to 24"

Installation Instructions



Unpacking

- Carefully remove the contents and lay them out on cardboard or other protective surface
- Check package contents against the parts list to ensure that all components were received undamaged. Do not use damaged or defective parts
- Carefully read all instructions before attempting installation

Safety Information

- Use proper safety equipment during installation
- If you don't understand the installation instructions, please consult an installation specialist
- This mount contains small parts which can act as a choking hazard if swallowed
- Do not use this product for any purpose or in any configuration not explicitly specified in these instructions

Tools Required

- Phillips screwdriver
- 3/8" drill bit and Electric drill (for grommet hole installation)
- Ratchet set or adjustable wrench

Parts List

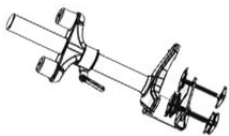

(1x) Tube Support with C-Clamp



(2x) Extension Arm

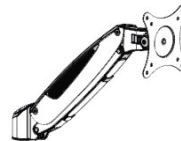

(2x) Spring Arm with VESA Plate

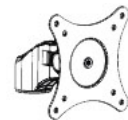

(1x) Middle VESA Plate



(12x) M4x12 Bolt



(12x) M4x30 Bolt



(1x) Position Ring

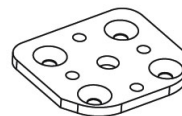

(1x) Grommet Plate



(12x) Spacer



(2x) Wire Clip

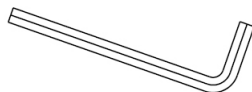

(3x) Allen Key (3mm, 4mm, 5mm)



(4x) M6x25 Bolt



(4x) Plastic Cap

Installation

Caution: This desk mount must be securely attached to the horizontal desktop. If the mount is not properly installed it may fall, resulting in possible injury and/or damage.

1A) C-Clamp Installation

1. Position the Tube Support to the desktop. Loosen the clamp screw according to the thickness of the desktop, see **Figure 1**.
2. Tighten the C-Clamp to the desktop by turning the clamp screw clockwise, see **Figure 2**.

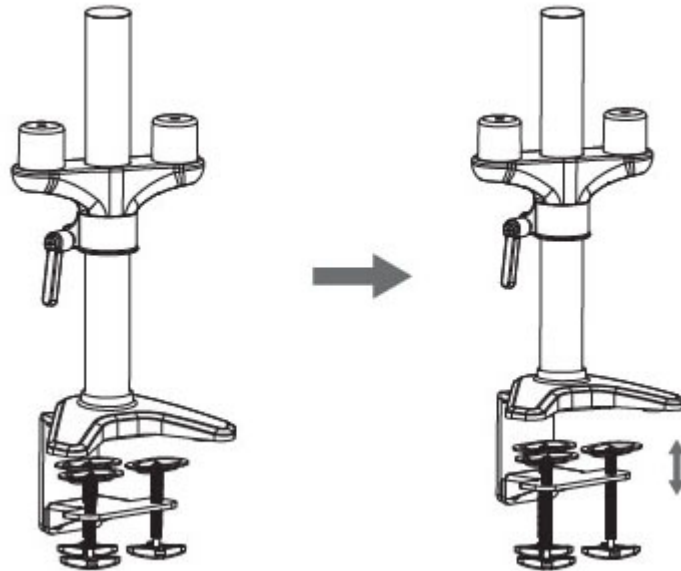

Figure 1

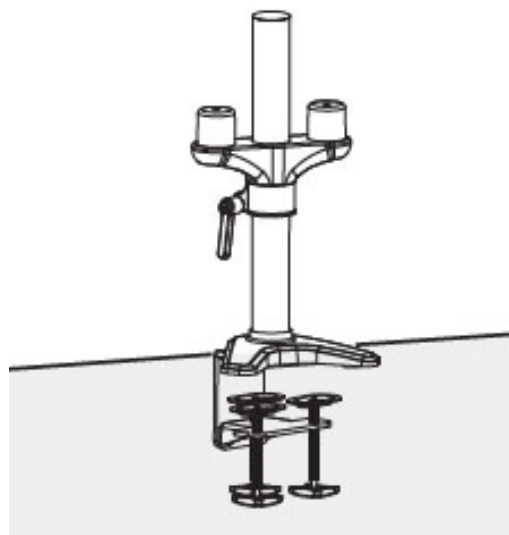

Figure 2

1B) Grommet Hole Installation

This installation requires you to either drill a 3/8" (10mm) diameter hole through the desktop or use an existing grommet hole (2.25" diameter max). **Note:** If the existing grommet hole comes with a plastic protector, remove it to ensure a flat surface before installing the Tube Support.

1. Use a 5mm Allen Key to remove the lower desk clamp from the upper desk clamp, see Figure 3.
2. Remove the support plate from one clamp screw using a Phillips screwdriver, then remove the clamp screw from the lower desk clamp, see Figure 4. **NOTE:** Only one clamp screw is required for the Grommet Hole installation.
3. Remove the plastic cushion, see Figure 5, then remove the upper desk clamp from the aluminum base by removing the screws using a 4mm Allen Key, see Figure 6.
4. Attach the Grommet Plate to the aluminum base, and secure it using the screws from step 3, see Figure 7.
5. Attach the plastic cushion to the bottom of the grommet plate, see Figure 8.
6. Position the Tube Support on the mounting surface and secure it using the support plate and clamp screw, see Figure 9 and Figure 10. **Warning:** Carefully screw the clamp screw into the grommet plate to prevent cross-threading and damage to the clamp screw.

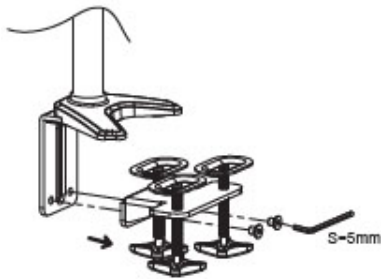

Figure 3

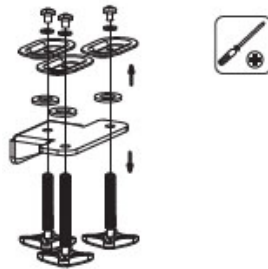

Figure 4

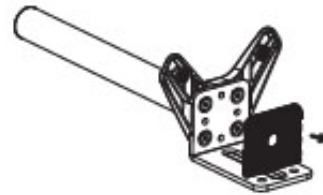

Figure 5

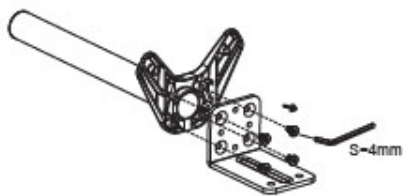

Figure 6



Figure 7



Figure 8



Figure 9



Figure 10

- 2-1. Install the **Position Ring** at the desired height and tighten the **Screw**, see **Figure 11**. Move the **Arm Support** so it rests on the Position Ring and tighten the **Hex Nuts** finger tight with a **3mm Allen Key**, see Figure 11.

Caution: DO NOT over tighten the Hex Nut. Over tightening the Hex Nut may result in damage to the support and steel tube.

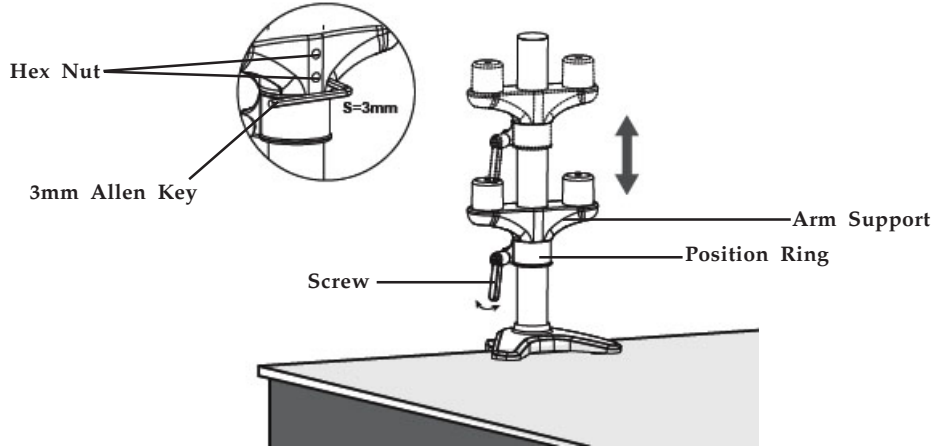

Figure 11

- 2-2. Install the **Extension Arm** to the **Arm Support**, use **M6x25 Bolt**, **Plastic Cap** and tighten finger tight using a Phillips screwdriver. Then tighten the 2 **Hex Nuts** finger tight using a **3mm Allen Key**, see Figure 12. Lastly, install the **Position Ring** onto the Tube Support and tighten the screw.

Caution: DO NOT over-tighten either M6x25 Bolt or Hex Nuts. The Extension Arm is intended to rotate and is not meant to be attached in a fixed position. Over tightening the M6x25 Bolt or Hex Nuts may result in damage to the Hex Nuts, Plastic Cap, Extension Arm or Arm Support.

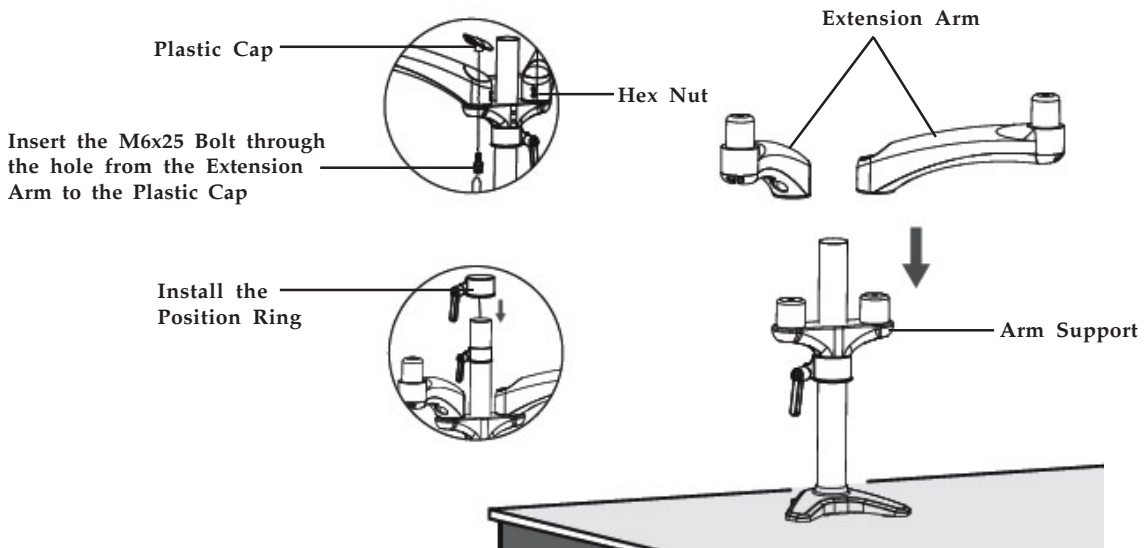

Figure 12

3. Mount the monitor to the Spring Arm with VESA plate and Middle VESA Plate.
- 3-A. For flat back surface use M4x12 Bolt, and tighten using a Phillips screwdriver, see Figure 13A.

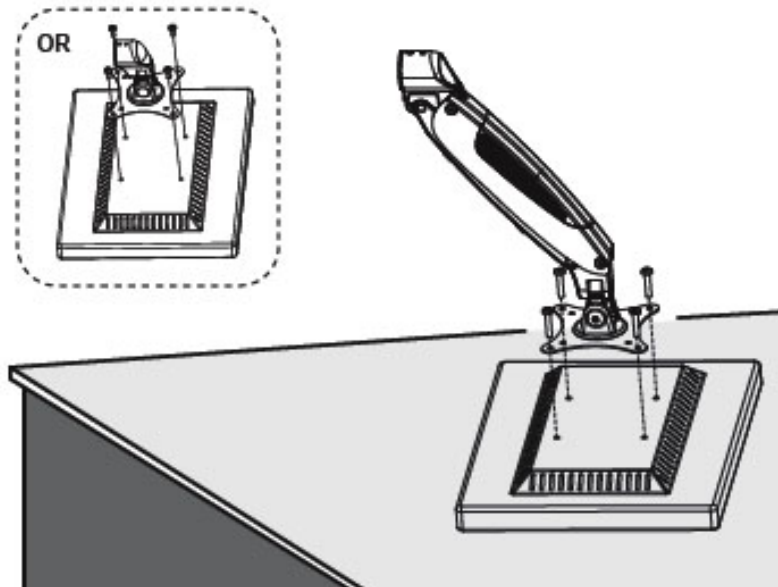

Figure 13A: Flat Back Monitor

- 3-B. For curved back/recessed surface use M4 Spacer with M4x30 Bolt, and tighten using a Phillips screwdriver, see Figure 13B.

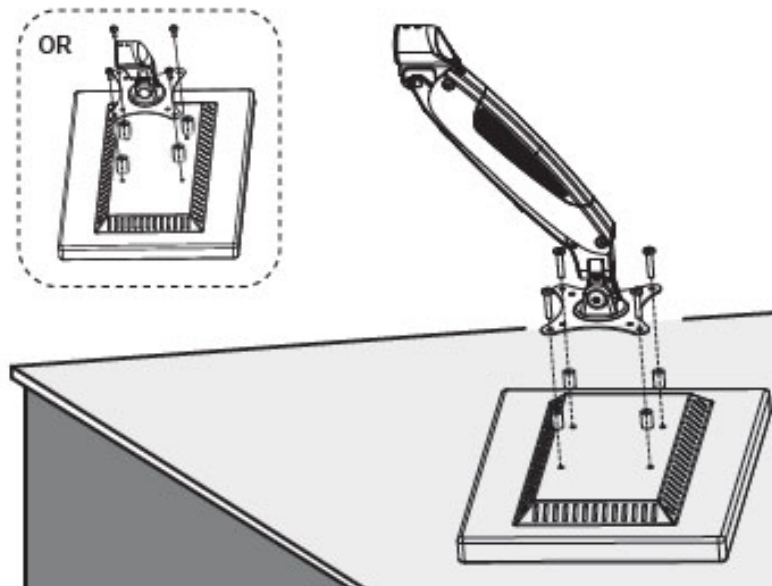

Figure 13B: Curved Back Monitor

4. Install the Spring Arm assembly to the Extension Arm, use **M6x25 Bolt** with **Plastic Cap** and tighten finger tight using a Phillips screwdriver. Then tighten the 2 **Hex Nuts** finger tight using a 3mm Allen Key, see **Figure 14**. Lastly, install the Middle VESA plate to the tube support so it rests on the Position Ring, and thighten the 2 Hex Nuts finger tight using a 3mm Allen Key.

Caution: DO NOT over tighten either M6x25 Bolt or Hex Nuts. The Spring Arm assembly and Middle VESA Plate are intended to rotate and is not meant to be attached in a fixed position. Over tightening the M6x25 Bolt or Hex Nuts may result in damage to the Hex Nuts, Plastic Cap, Spring Arm, Middle VESA Plate, or Extension Arm.

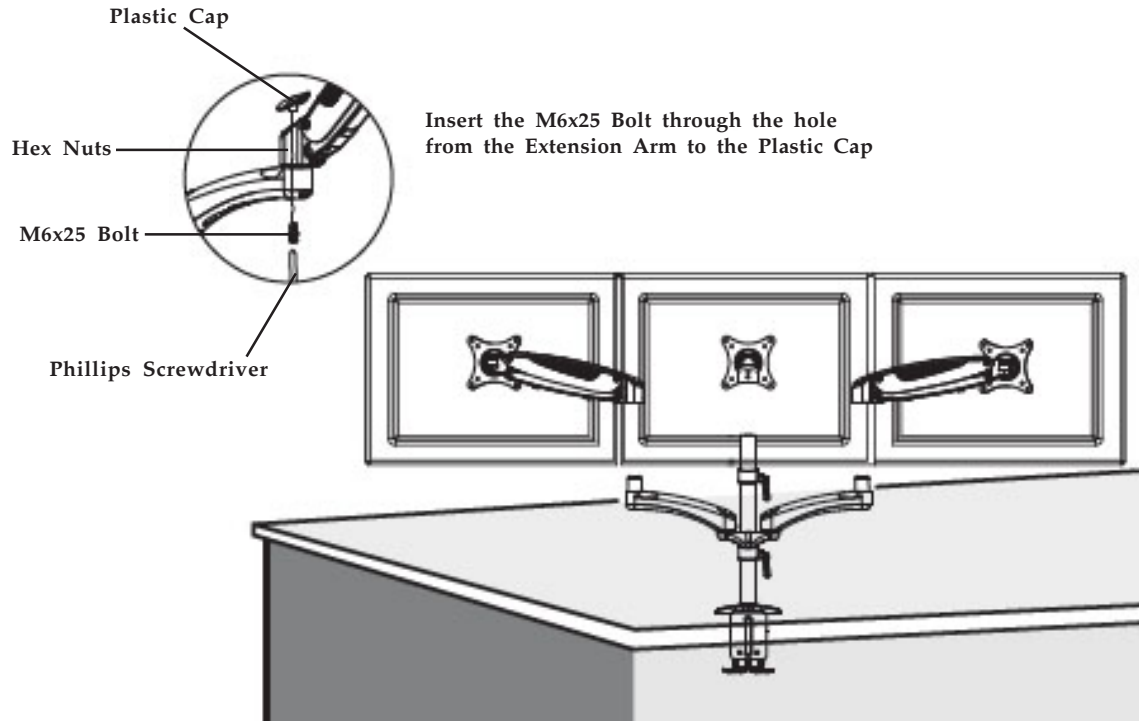
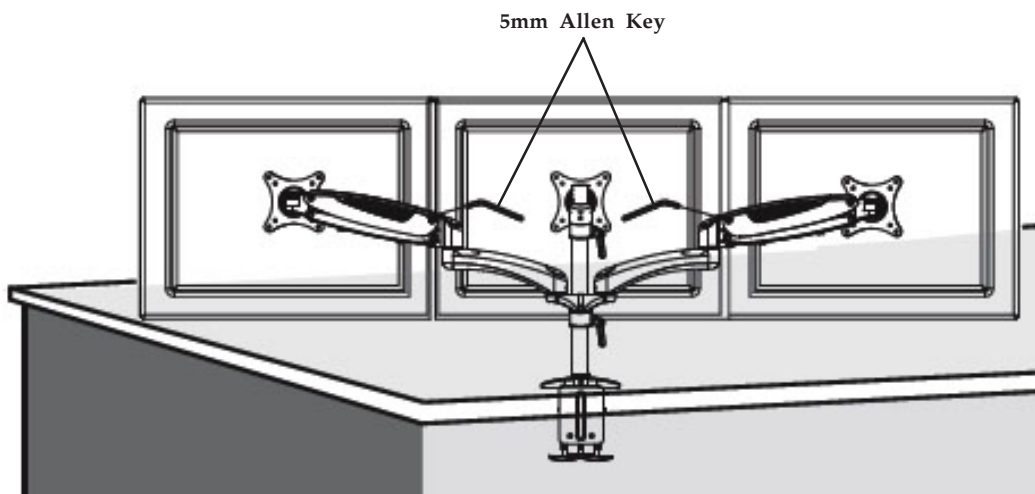
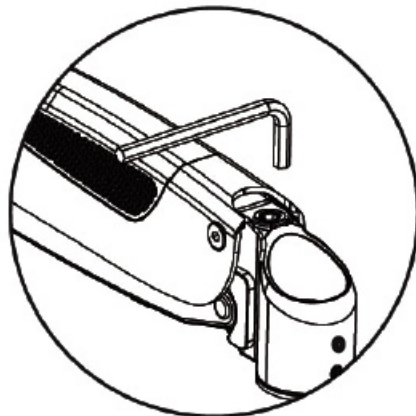

Figure 14: Attach the Spring Arm and Monitor assembly to the Extension Arm

5. Check the tightness, arrange the cables, and make any final adjustments.



Adjust the Tension of the Gas Shock using a 5mm Allen Key



NOTE: turn clockwise to reduce tension for lighter monitors and counter-clockwise to increase tension for heavier monitors.

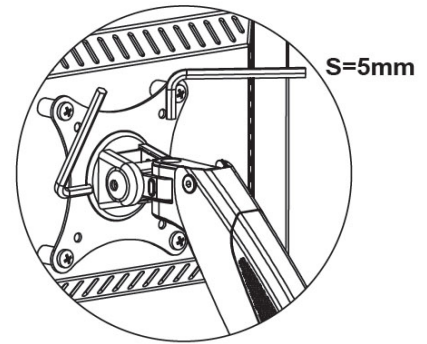
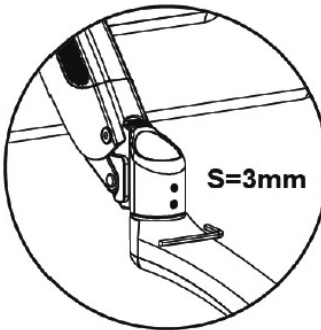
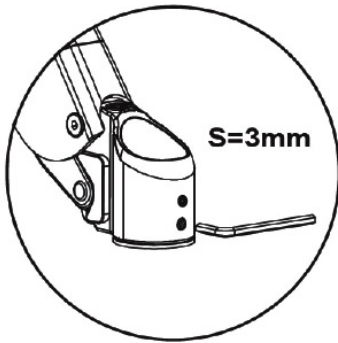

Adjust Tightness of the Extension Arm and Spring Arm pivot joint using a 3mm Allen Key

Adjust Tightness of Monitor Tilt and Swivel joint using a 5mm Allen Key

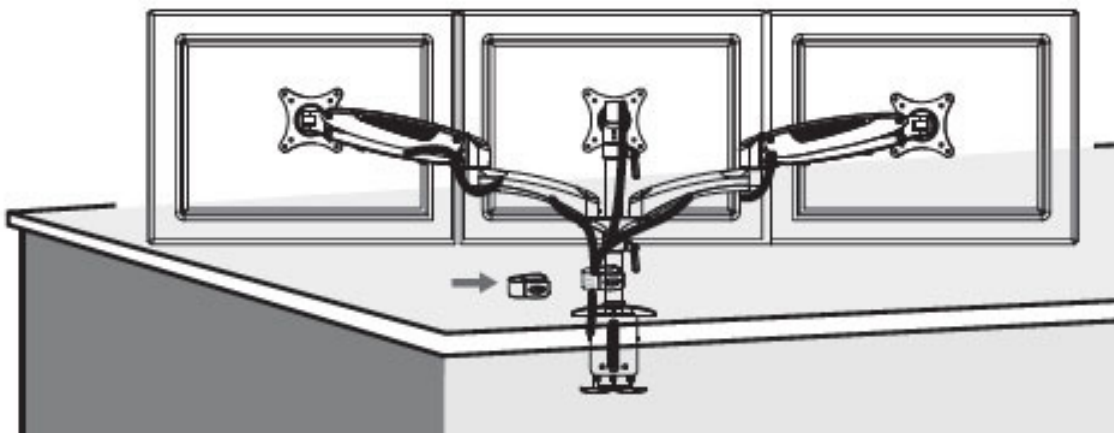

Arrange the cables into the cable covers and down the steel tube using the included Wire Clips

Maintenance

Check the mounting screws every two months for tightness.

Blank Page

Blank Page

Technical Support and Warranty

QUESTIONS? SIIG's **Online Support** has answers! Simply visit our web site at www.siig.com and click **Support**. Our online support database is updated daily with new drivers and solutions. Answers to your questions could be just a few clicks away. You can also submit questions online and a technical support analyst will promptly respond.

SIIG offers a 3-year manufacturer warranty with this product. This warranty covers the original purchaser and guarantees the product to be free of any defects in materials or workmanship for three (3) years from the date of purchase of the product.

SIIG will, at our discretion, repair or replace (with an identical product or product having similar features and functionality) the product if defective in materials or workmanship. This warranty gives you specific legal rights, and you may also have other rights which vary from state to state. Please see our website for more warranty details.

If you encounter any problems with this product, please follow the procedures below.

A) If it is within the store's return policy period, please return the product to the store where you purchased from.

B) If your purchase has passed the store's return policy period, please follow the steps below to have the product repaired or replaced.

Step 1: Submit your RMA request.

Go to www.siig.com, click **Support**, then **Request A Product Replacement** to submit a request to [SIIG RMA](#) or fax a request to 510-657-5962. Your RMA request will be processed, if the product is determined to be defective, an RMA number will be issued.

Step 2: After obtaining an RMA number, ship the product.

- Properly pack the product for shipping. All accessories that came with the original package must be included.
- Clearly write your RMA number on the top of the returned package. SIIG will refuse to accept any shipping package, and will not be responsible for a product returned without an RMA number posted on the outside of the shipping carton.
- You are responsible for the cost of shipping to SIIG. Ship the product to the following address:
SIIG, Inc.
6078 Stewart Avenue
Fremont, CA 94538-3152, USA
RMA #: _____
- SIIG will ship the repaired or replaced product via Ground in the U.S. and International Economy outside of the U.S. at no cost to the customer.

About SIIG, Inc.

Founded in 1985, SIIG, Inc. is a leading manufacturer of IT connectivity solutions (including Serial ATA and Ultra ATA Controllers, FireWire, USB, and legacy I/O adapters) that bridge the connection between Desktop/Notebook systems and external peripherals. SIIG continues to grow by adding A/V and Digital Signage connectivity solutions to our extensive portfolio. All centered around the distribution and switching of A/V signals over CAT5/6, these products include matrix switches, distribution amplifiers, extenders, converters, splitters, cabling, and more.

SIIG is the premier one-stop source of upgrades and is committed to providing high quality products while keeping economical and competitive prices. High-quality control standards are evident by one of the lowest defective return rates in the industry. Our products offer comprehensive user manuals, user-friendly features, and most products are backed by a lifetime warranty.

SIIG products can be found in many computer retail stores, mail order catalogs, and e-commerce sites in the Americas, as well as through major distributors, system integrators, and VARs.

<p>PRODUCT NAME</p>

<p>Triple Monitor Desk Mount - 13" to 24"</p>

Triple Monitor Desk Mount - 13" to 24" is a trademark of SIIG, Inc. SIIG and the SIIG logo are registered trademarks of SIIG, Inc. All other names used in this publication are for identification only and may be trademarks of their respective owners.