



# Full-Motion TV Mount - 26 to 55

## Installation Guide



P/N: CE-MT3712-S1  
04-1280A

### 1. Technical Parameter

Suit for TV size: 26"-55"; Max loading: 35kgs; Tilt: -15~+15 degrees; Distance to wall: 75-465mm

### 2. Parts List

Please check the parts in the package in comparison with the following list, make sure all of the parts are in the package. Never use defective parts, never replace part with different specification.

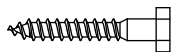

(A)M8x50 Self-tap Screw (4)



(B)10x50 Plastic Anchor (4)



(C-1)M8x22 washers (4)



(C-2) Bubble level(1)



(D)Square Washer (4)



(E)14mm Plastic Sleeve (4)



(F)M5x30 screws(4)



(G)M6x30 screws(4)



(H)M8x30 screws(4)



(I) 4mm (1)

### MAINTENANCE

Check that the bracket is secure and safe to use at regular intervals (at least every three months)

### Support

For more info or tech support <http://www.siig.com/support>

### 3. Installation and operation instructions

Note: please read the instructions carefully before installation!

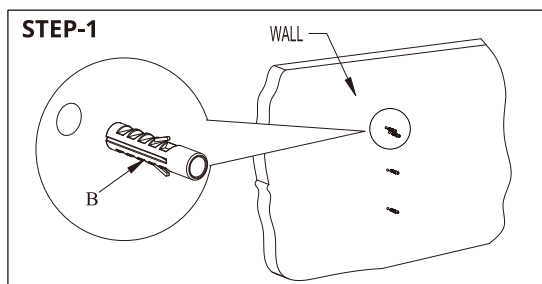

#### Step1:

Use the wall plate as a template to drill four holes of dia. 10mm and 50mm depth in the wall. Then wedge four plastic anchors into the holes.

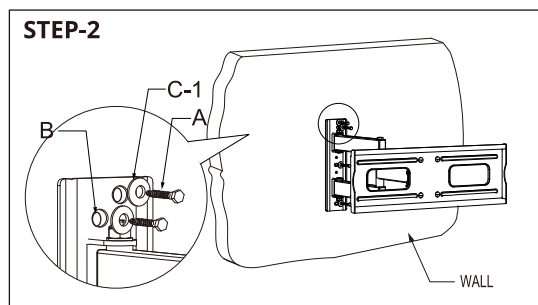

#### Step2:

Install the wall plate .Put the wall plate on the wall ,and then screw four lag bolts into each plastic concrete anchor through metal washer to four the lag bolt ,the plastic concrete anchor and the wall.

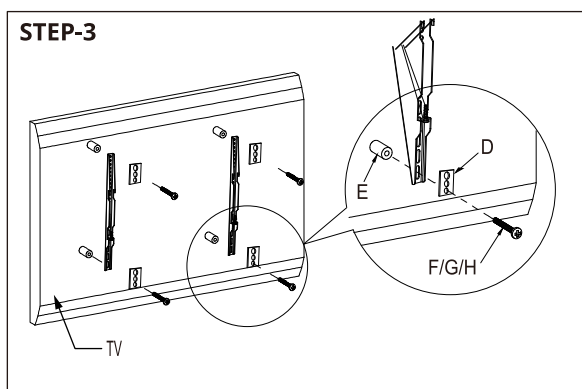

#### Step3:

Install the bracket rail onto the back of the TV: Select suitable screws from the screw package according to the size of the holes in the back of TV. Fix the two hanging arms onto the back of TV by screws into the holes. Make sure equal height of the two hanging arms.

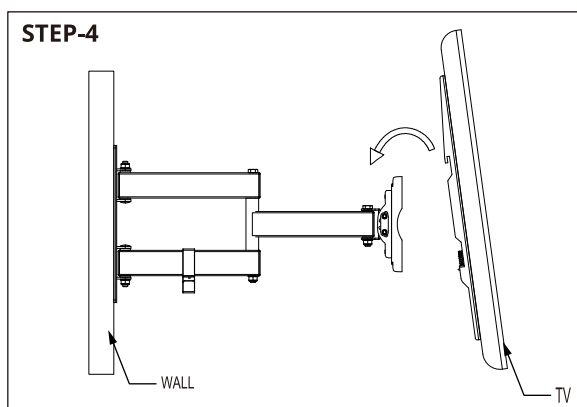

#### Step4:

Hang the two monitor brackets on the wall plate, relax the hands until they are

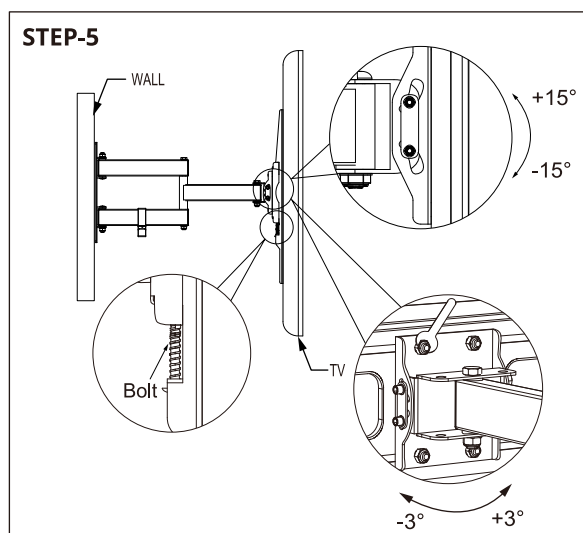

#### Step5:

A. Fix the two bolts under the monitor brackets inside of the wall plate and then screw them down.

B. Adjust the angle of the panel TV between -15 and +15 degrees suitable position, and screw the knobs.

C. After the TV is installed, use the level adjustment to make sure the TV is level before moving forward.